

Rokku iPad Security Table Stand

iPad Air / Air2 / Pro 9.7

1. Align the iPad enclosure with the stand bracket and carefully screw in the (4) provided screws.

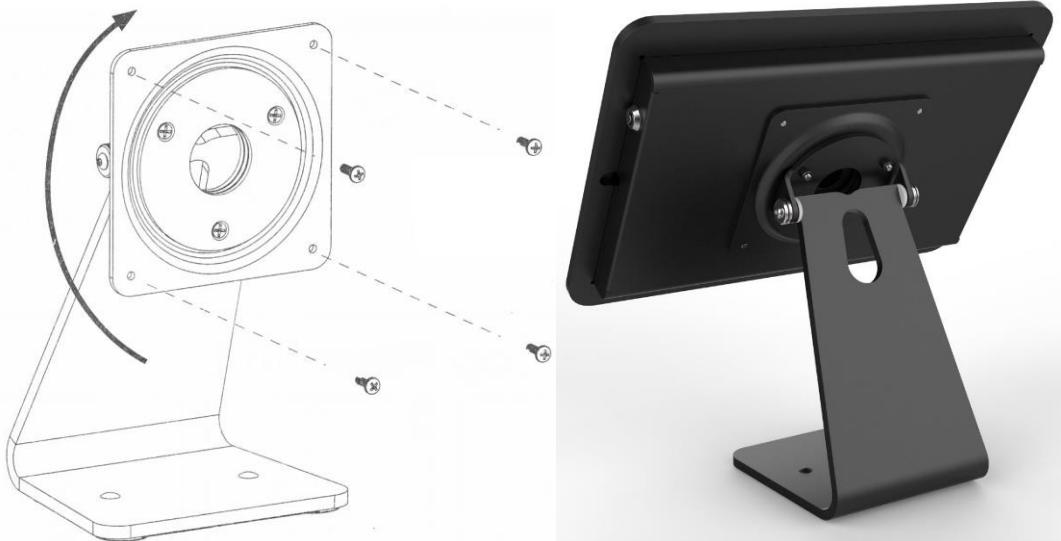

2. Insert your iPad into the enclosure and place the brackets inside to secure the iPad in place. Place the frame lining over the iPad so that it sits flushed with the frame and push the lock in till it clicks.



Please call our support team if you need assistance
setting up your rental devices
1(800) 622-6484